

# FLOOR STOPS

## GENERAL HARDWARE

### SPRING STOP – UNIVERSAL

C230



C230-26D

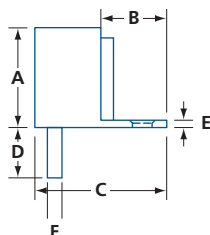

- For interior use with or without threshold
- Zinc die-cast body
- Spring loaded non-marking rubber stop
- Mounting hardware included: wood screw and anchor

MODEL	FINISH	A	B	øC	D	E	øF	/BOX
C230	19, 26D	1½ (38)	15/16 (24)	17/8 (47.4)	13/16 (21)	7/32 (6)	7/32 (5.6)	100

IN (MM)

### FLOOR-MOUNTED DOOR STOP

R470, R471



R470C26D

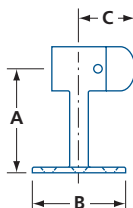

- For exterior / interior use
- Solid brass
- Non-marking rubber tip
- Mounting hardware included:
  - #R470 - wood screws
  - #R471 - lead shielding, masonry anchor, wood screws
- #R470REP - Replacement rubber tip

MODEL	FINISH	A	øB	C	/BOX
R470	C10B, C26D, C3	2½ (64)	23/16 (56)	15/16 (33.3)	12
R471	C26D, C3	2½ (64)	23/16 (56)	15/16 (33.3)	12

IN (MM)

