



INSTALLATION INSTRUCTIONS FOR SINGLE OR DOUBLE CYLINDER DEADBOLT



FOR USE ON DOOR THICKNESS OF 1-3/8" TO 2-1/4" (35-57mm)

Document provided as-is, manufacturer reserves the right to make technical changes without prior notice.

TOOLS REQUIRED FOR NEW CONSTRUCTION:

Philips head screw driver
2-1/8" (54mm) hole saw
1" (25mm) drill
Chisel

TOOLS REQUIRED FOR REPLACEMENT:

Philips head screw driver

1. MARK DOOR

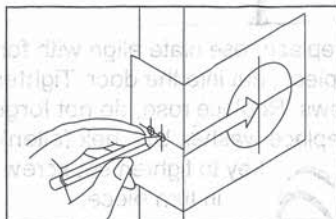

- Fold and apply template on bevelled edge of door and mark center of door edge as indicated on template at the desired height from the floor.
- Mark center hole on door face through guide on template for 2-3/4" (70mm) backset.

NOTE: BACKSET ON DOOR FACE MUST BE SAME AS BACKSET OF YOUR LOCK.

2. DRILL HOLES

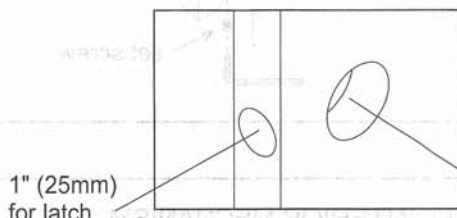

Drill holes as marked.

NOTE: DRILL 2-1/8" (54mm) HOLE FROM BOTH SIDES OF DOOR TO AVOID SPLITTING WOOD.

3. INSTALL LATCH

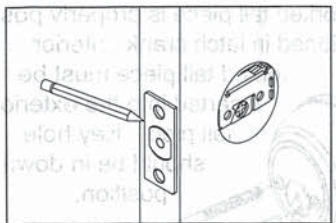

Insert latch in hole, mark outline of faceplate and remove latch.

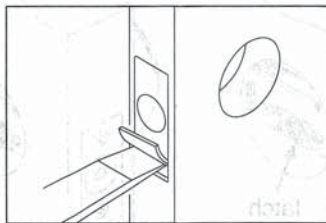

Chisel 1/8" (3mm) deep or until faceplate flush with door edge.

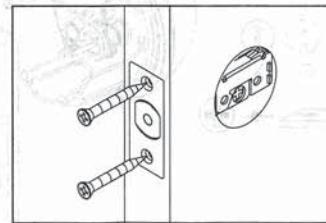

Insert latch and tighten screws.

4. INSTALL STRIKE BOX & STRIKE

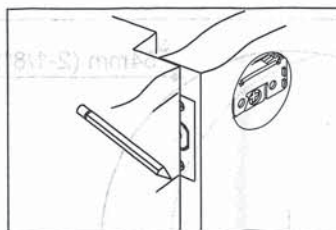

Close door to mark horizontal center line of strike.

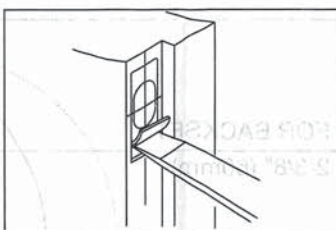

Measure one half of door thickness from door stop and vertically mark center line of strike. Drill aperture which is same with strike box 1-9/64" (29mm) deep at inter section of horizontal and vertical center line of strike. Match screw hole on strike with center lines on jamb. Mark outline and chisel 9/32" (7mm) deep for strike.

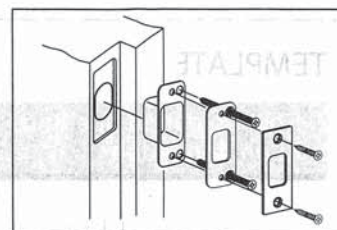

Install strike box and strike and tighten screws.

5. INSTALL SINGLE CYLINDER

INSTALL EXTERIOR MECHANISM - SINGLE CYLINDER

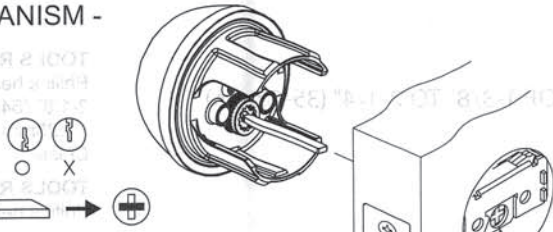

Tapped holes in housing of exterior cylinder should be lined up with screw holes. (Key hole should be in down position.)

FORKED TAIL PIECE SHOULD BE HORIZONTALLY INSERTED INTO LATCH CRANK.

INSTALL INTERIOR MECHANISM - SINGLE CYLINDER

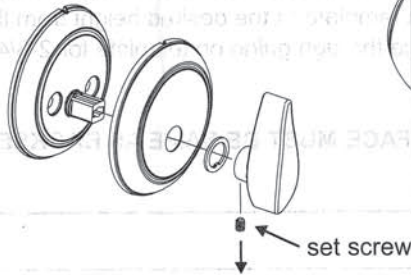

First use hex (allen) key to remove set screw, remove turn piece and washer. Separate rose and rose plate.

To replace rose plate align with forked tail piece, put into the door. Tighten screws. Replace rose, do not forget to replace washer. Use hex (allen) key to tighten set screw in turn piece.

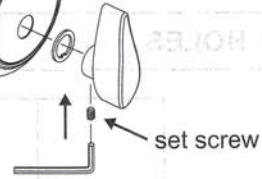

6. INSTALL DOUBLE CYLINDER

INSTALL EXTERIOR MECHANISM - DOUBLE CYLINDER

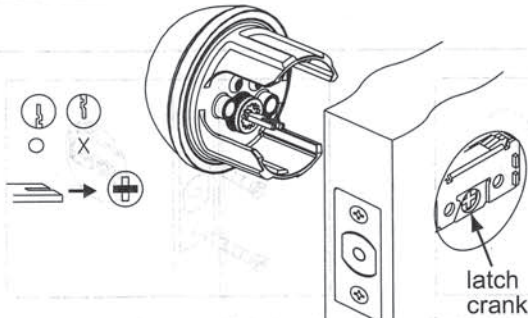

Press exterior cylinder flush against door. Exterior forked tail piece should be horizontally inserted into latch crank first.

INSTALL INTERIOR MECHANISM - DOUBLE CYLINDER

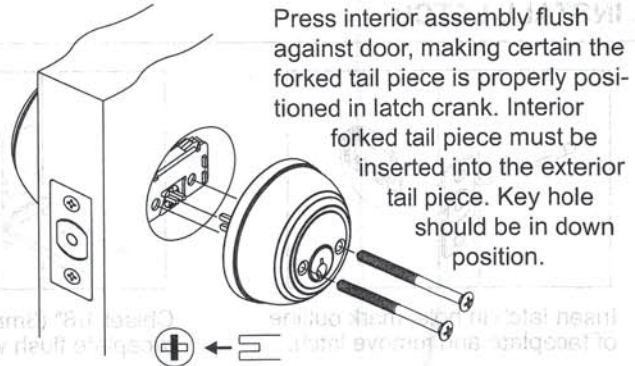

Press interior assembly flush against door, making certain the forked tail piece is properly positioned in latch crank. Interior forked tail piece must be inserted into the exterior tail piece. Key hole should be in down position.

Insert two screws through countersunk holes engaging holes in exterior cylinder and tighten firmly.

TEMPLATE

Fold on dotted line and fit on door edge

55 50 45 40 35
2-3/16" 2" 1-3/4" 1-9/16" 1-3/8"

Mark 1" (25.4mm) hole at center of door edge.

DO NOT USE IF NOT TO SCALE

FOR BACKSET
2-3/8" (60mm)

FOR BACKSET
2-3/4" (70mm)

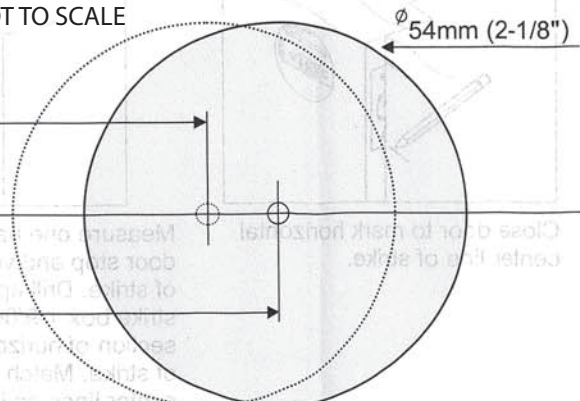

SCANNED DOCUMENT
- Do not use template,
for reference only.